



# JET FILTER

## FEATURES

- High capacity dedusting
- Compact and lightweight design
- Low energy cost
- Easy filter bag change
- With automatically controlled solenoid valves
- Regular filter bag cleaning
- Filter bag with differential pressure sensor cleaning and change time control



FEED



BIOMASS



BY-PRODUCT  
PELLETING



CHEMISTRY



SOYBEAN  
PROCESSING



PREMIX AND  
CONCENTRATE



ORGANIC  
FERTILIZER  
PROCESSING



GRAIN  
HANDLING AND  
STORAGE



## JFHM – JFHL SERIES JET FILTER

Use of a suitable jet filter is the most important factor for a smooth grinding process and high mill performance.

**The surface area of the jet filter is selected according to the mill sieve size and the amount of air required for aspiration.**

An aspiration fan system vacuums air from inside the filter bags. The fan helps trap the dust in the polyester needle filter bags. With the signal coming from the pulse valves by the electronic program unit, the compressed air is blown into the filter bag and the dust adhering to the bag is cleaned by shaking and the dust is included in the system.

The differential pressure sensor warns the operator for the maximum efficiency of the equipment to which it is connected by showing that the filter bags should be changed or cleaned.

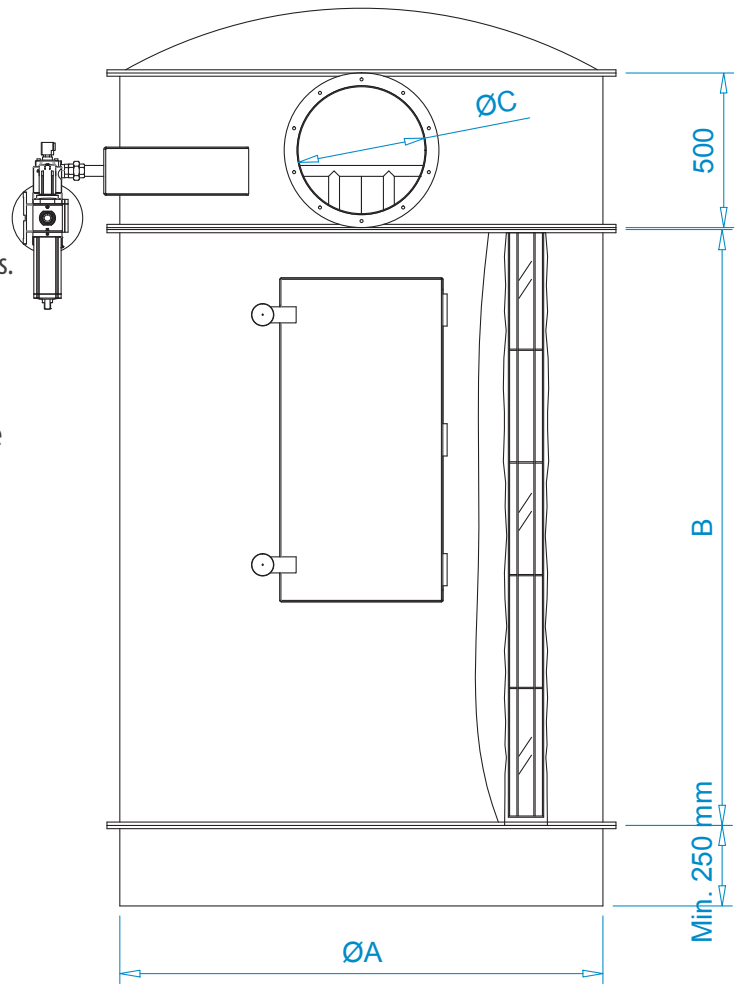

### AREAS OF USAGE

- Poultry Feed Mill
- Ruminant Feed Mill
- Aquatic Feed Plant
- Pet Food Plant
- Chemical Plant

MODEL	DIMENSIONS (mm)			FILTER AREA (m <sup>2</sup> )
	A	B	C	
JFHM 16	1000	1850	400	11
JFHM 25	1160	1850	400	17,5
JFHM 36	1436	1850	400	25
JFHM 48	1500	1850	400	34
JFHM 52	1600	1850	400	36
JFHM 64	1600	1850	400	45
JFHL 16	1000	2350	400	14
JFHL 25	1160	2350	400	22
JFHL 36	1436	2350	400	32
JFHL 48	1500	2350	400	42
JFHL 52	1600	2350	400	46
JFHL 64	1600	2350	400	56